

# M-674 (Shower room)

## Installation and Operation Instruction

### Packing list (FIGURE 1):

Number	Name of accessories	quantity
1	Fixed glass	2pieces
2	Side waterproof plastic strip	2pieces
3	Plastic particles	5pieces
4	4*30screw	5pieces
5	Slide	2pieces
6	Pulley	5pieces
7	Plastic magnetic stripe	2pieces
8	Vaulted strip	2pieces
9	Handle	1pieces
10	Adjustable glass	1pieces

### Requisite Tools:

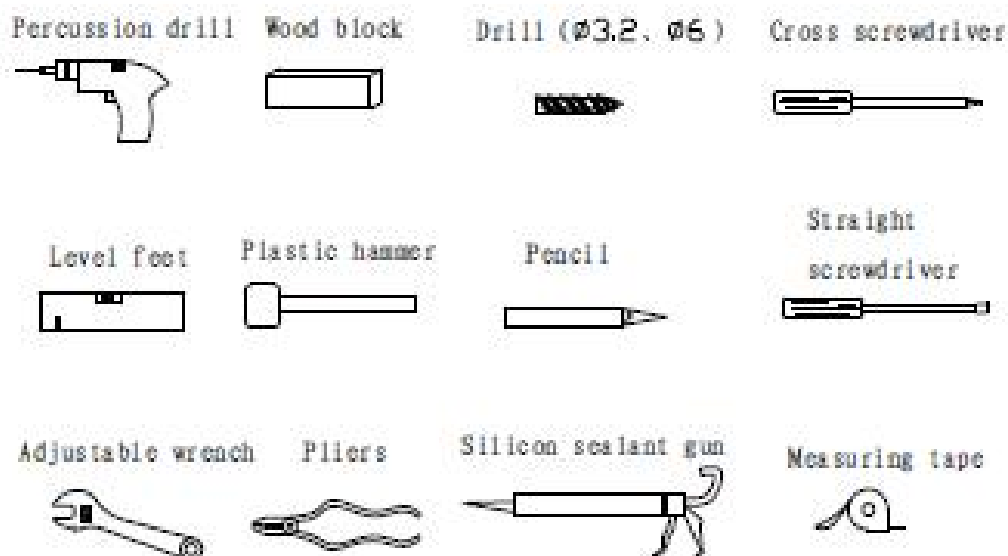

## General assembly drawing:

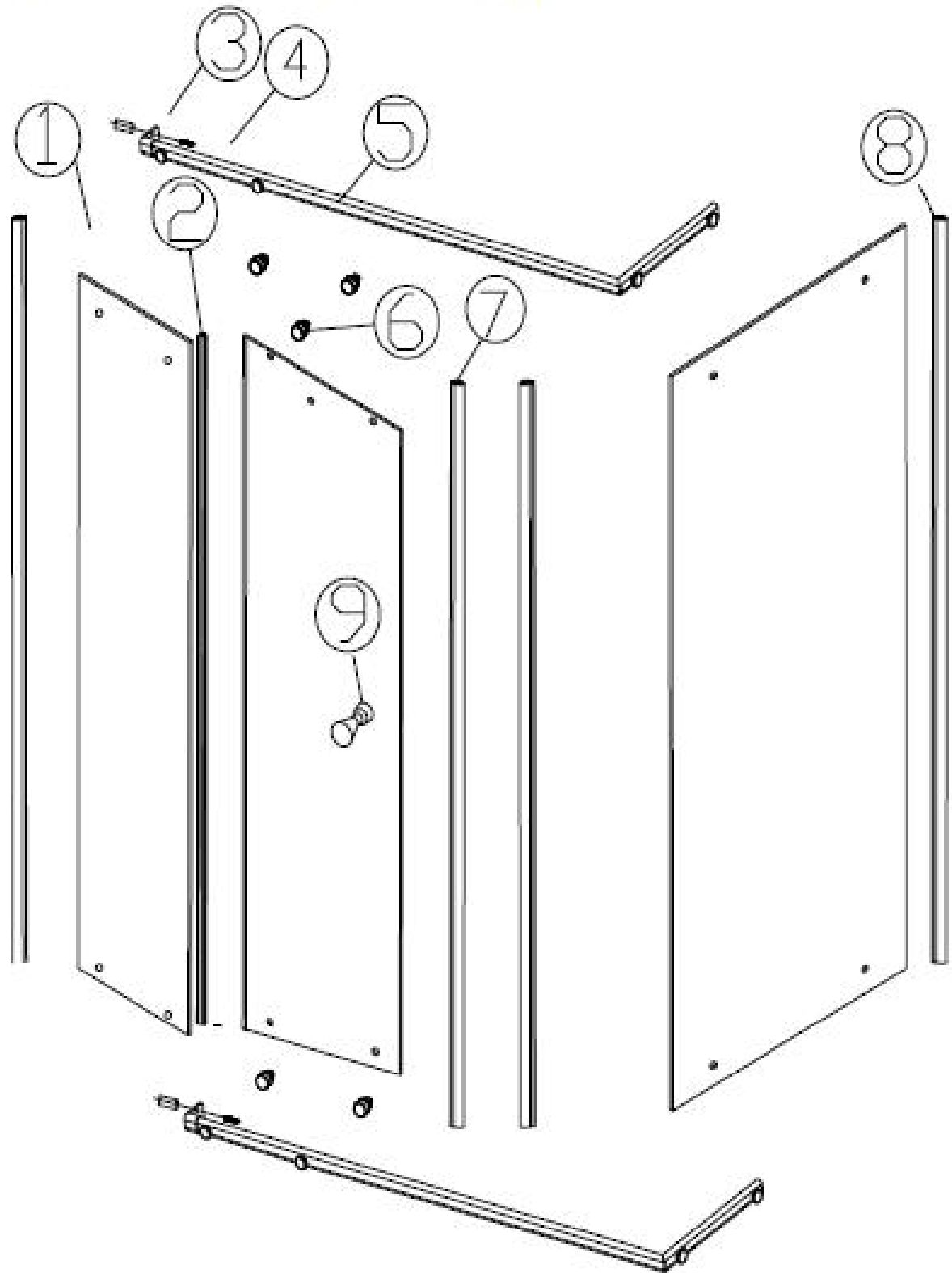

First insralled shower tray.Installation steps are as followes:

Figure 2

First,set aside the outfall level in the washroom befor the installation of shower tray should match with the outfall level. (Figure2)

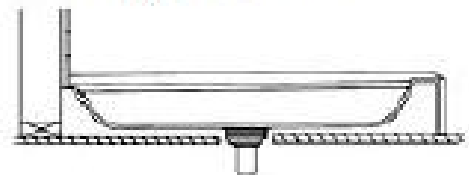

Figure 3

Second,if the outfall level of washroom has been fixed,and can not be adjusted to match with the drainage hole ,then connect a hose for both . Make sure there is enough space for connecting hoses through the drainage hole and the ground outfall level.(Figure 3)



Third,adjust the bottom of chassi s framae to makw the side of drainage hole slightly lower(Figure 4)

Figure 4

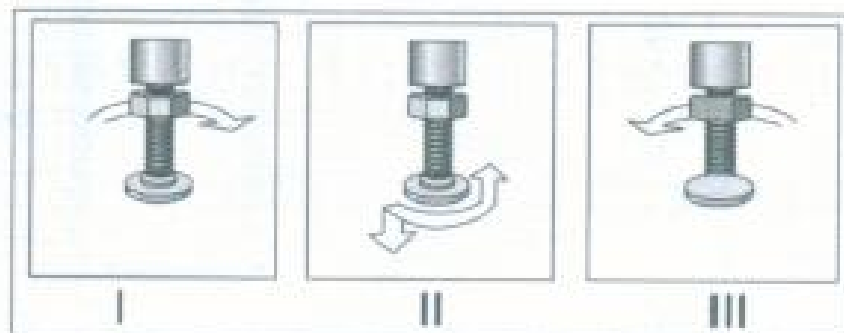
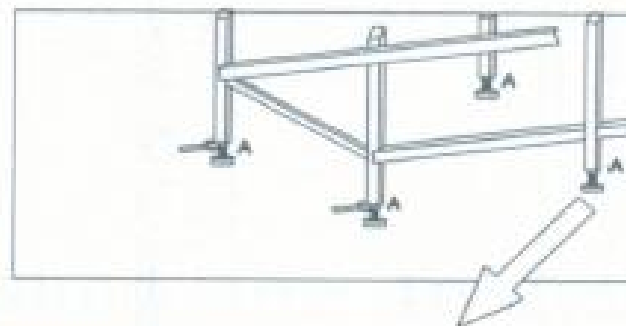

## The installation steps of the shower body:

1. Located the two pieces of fixed glass and slide with screw, referring to the following size by slide from up to down, mark the place for holes on the wall. Punch holes in the wall with the  $\Phi 6$  percussion drill (A), knock the plastic colloid into the drilled holes (B).
2. According to the figure 7, Install the pulley and lock the hexagonal nut as shown by Figure 5, suspend the upside pulley onto the top glide, and put the bottom pulley into glide groove. Then cover the glass hole and lock the nut.

Figure 5

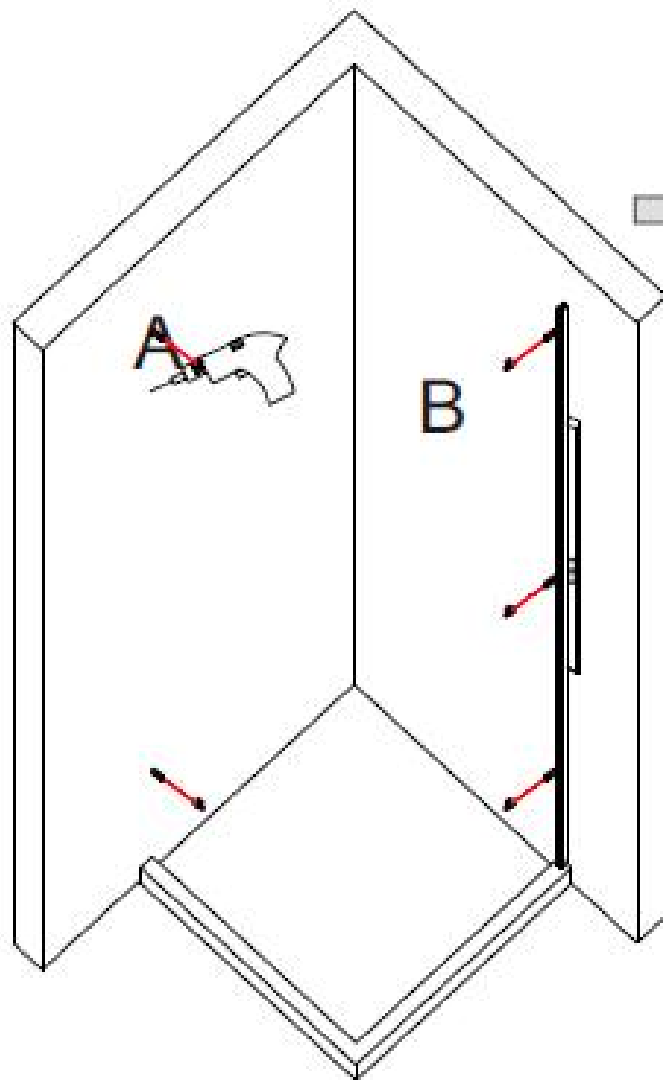
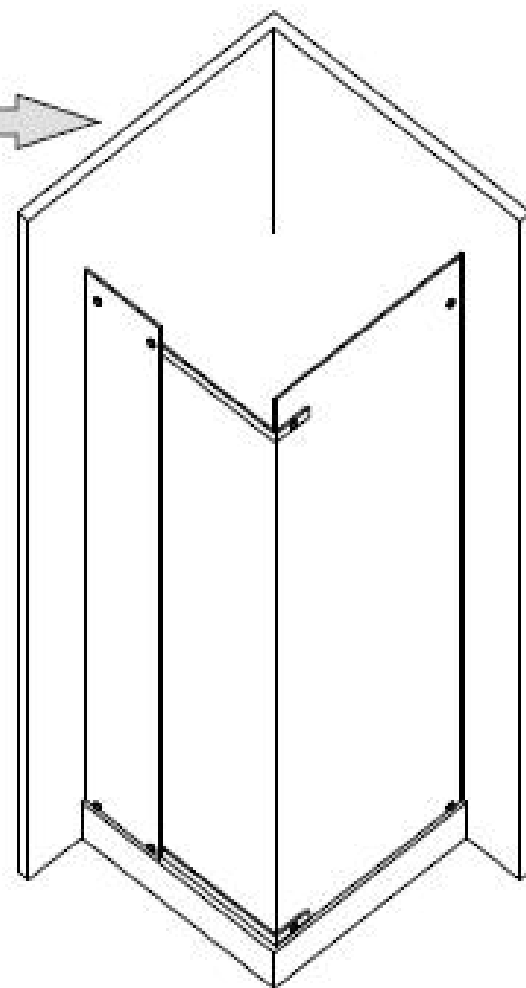

Figure 6



3. Adjusting the pulley from top to bottom, so that it appropriately elastic, smoothly slide and make the magnetic stripes closely absorbed. Figure 7)
4. Insert the Side waterproof plastic strip and Plastic magnetic stripe in the side of fixed glass and Adjustable glass.
5. use the silicon sealant gun to fill the cracks among shower body, tray and wall. (Figure 9)

Figure 7

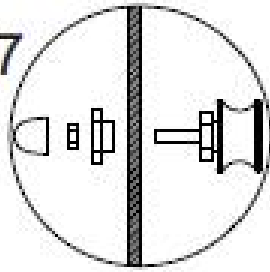
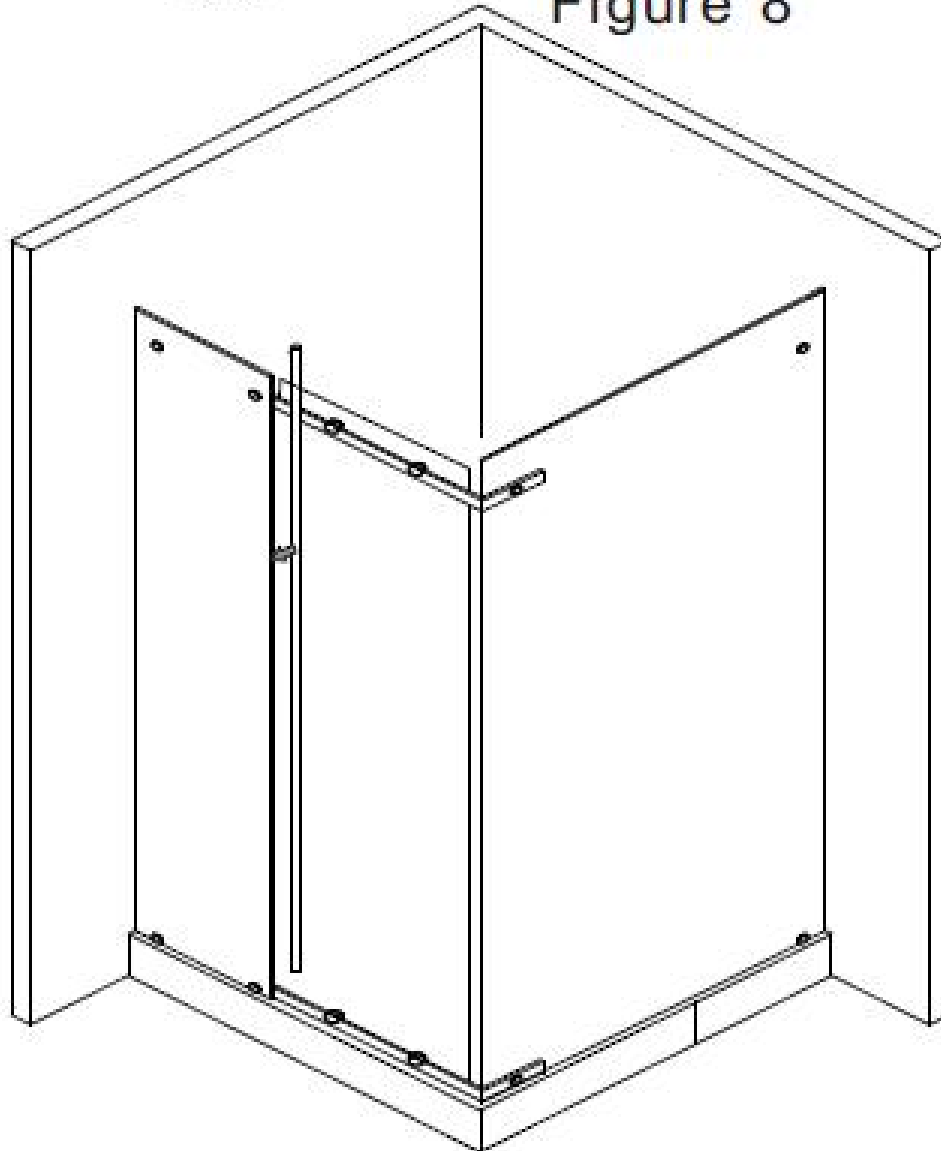
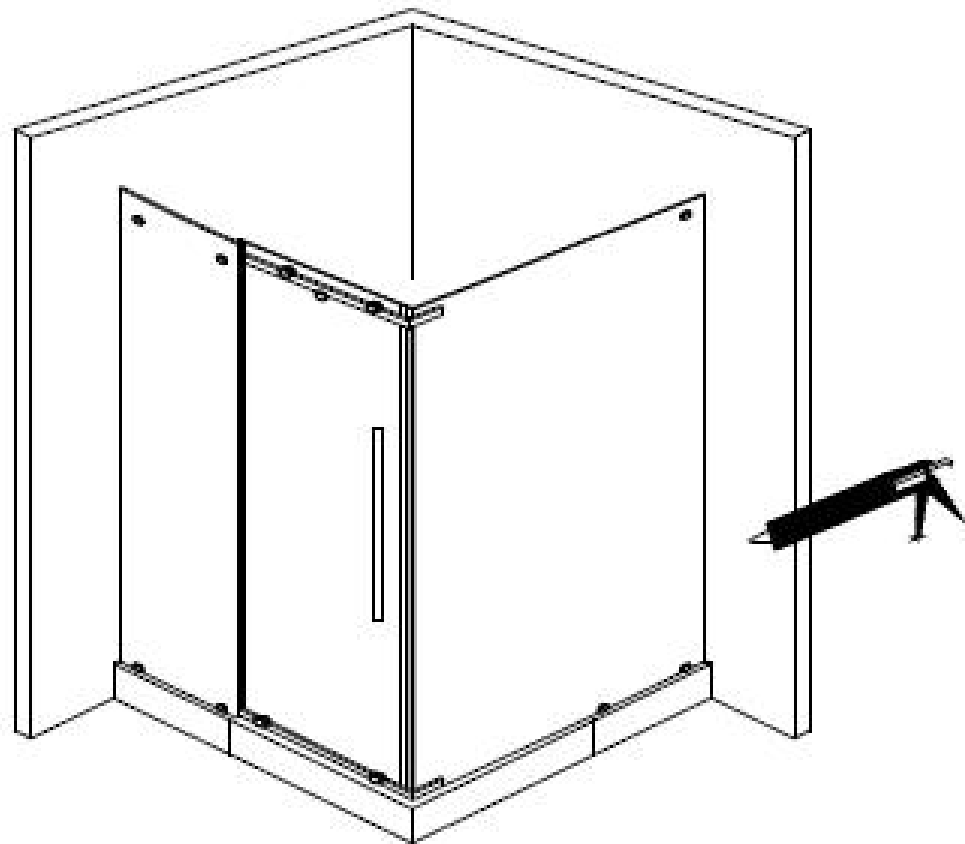

Figure 8





## Manitenance Methods and Notes

- 1, Use soft,dry cloth when cleaning the walls and chassis of shower room.  
For trivial dirt, use soft cloth or sponge with neutral detergent to clean.  
Please do not use Nylon products to clean, or it will lose the luster of shower room , and create dirt.
- 2, For the dense dirt, please use alcohol to remove them. When using the bathroom-exclusive detergent, please make sure to use it at a proper way and note on their container. Improper usage will have a negative impact on the human body, and create some adverse conditions on the products.
- 3, When using the Mildew, please operate it by Mildew Manual instructions. After finished, clean it with water and dry it with cloth.
- 4,If waterproof filler loses,it will lead to leakage. Therefore,once lost, be sure to re-filled.
- 5,When cleaning ,please do ot use the following items, cause they would have a negative impact on the human body, and will result in some adverse conditions on products. Those items included:acidic and alkaline solvent, drugs(such as hydrochloric acid),thinner and other solvents acetone, decontamination powder, polishing detergent, nylon broom,sand paper, and etc.
- 6,In daily usage, add some lubricant to the pulley,ensure for easy-usage and better-maintenance.